

**Get your
ready-made
steel building
in 30 days***

*FAST & STRESS-FREE
CONSTRUCTION*

*Excludes installations
*Terms and conditions apply

Classrooms



GET IN TOUCH FOR MORE INFO

 +254 788 20 20 20  sales.sbs@safalgroup.com

 Safal Building Systems Ltd. (100% Subsidiary of MRM)
P.O Box 271 - 00204, Athi River

Available in: (per unit)

| Width(m) | Length(m) | Height(m) | Pitch(Deg) |
|----------|-----------|-----------|------------|
| 6 | 8 | 3 | 15 |
| 6 | 32 | 3 | 15 |



Classroom_6x8x3M_Single Unit



Classrooms_6x32x3M_4 Unit Block

FLOOR PLAN
6x8x3M SINGLE UNIT

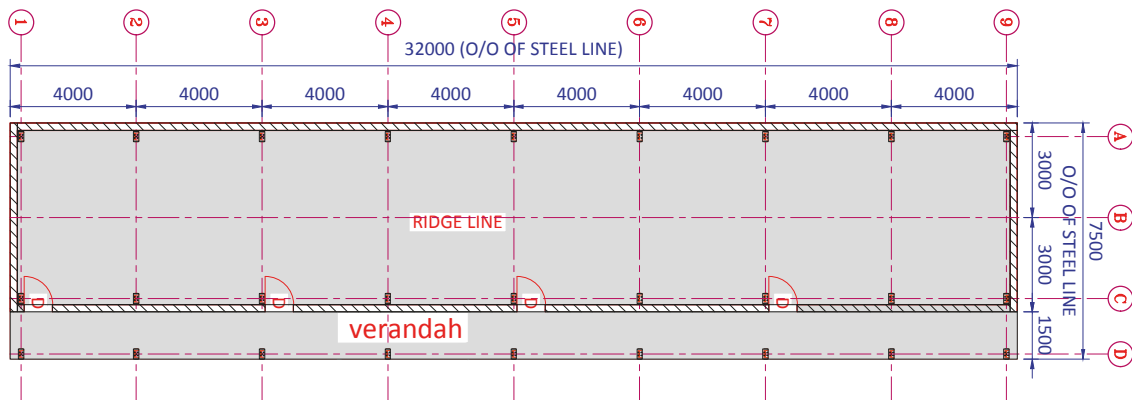
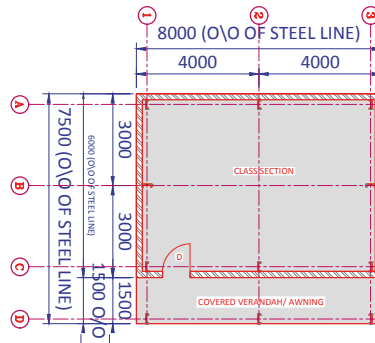

FLOOR PLAN
6x32x3M 4UNIT BLOCK